

**FIRST RE-ESTABLISHMENT**

**GCDB 700700**

Township Corner - Closing Corner.

Found:

- 35x15x5 Stone Marked CC and 6 notches
- 60" now 64" Douglas Fir, S.30°W. 1.3 feet, shows good scar.
- 30" Douglas Fir, now rotten stob, N.41°E. 18.5 feet.
- 40" Douglas Fir, now rotten stob, N.74°W. 27.7 feet. T. 31 S. Douglas County.

Set Brass cap Twp. Cor. Mkd:

County Surveyor	T. 31 S. Doug Co			
Office	R	S36		R
1968	1	—		S31 1
	W	S1		CC E
	Jack. Co.			

New BTs:

- 9" Douglas Fir N.2½°E. 11.5 feet. Marked: T31S R1E S31 CC CS BT.
- 9" Douglas Fir N.26°W. 17.2 Feet. Marked: T31S R1W S36 CC CS BT.

August 9, 1968  
 John M. Powell  
 Douglas County Surveyor's Office

Frank Jones  
 W. Penley

**SEE NEXT PAGE FOR SECOND RE-ESTABLISHMENT**

**SECOND RE-ESTABLISHMENT  
GCDB 700700**

Closing corner common to Section 36 of Township 31 South, Range 1 West and Section 1 of Township 32 South, Range 1 West, W.M.

Found at the corner position, exposed 10 ins. in a mound of stones, the 1 in. diam. galv. iron pipe with a 2½ ins. diam. brass cap set the Douglas County Surveyor in 1968 and marked:

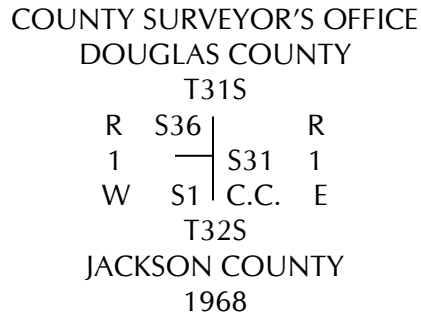

No original evidence found.

Bearing trees recorded by Douglas County in 1968 found with healed double blazes and measured to center at base;

- Fir dead and down brs. record N26°W, 17.2 ft.
- Fir snag brs. record N2½°E, 11.5 ft.
- Fir now 54 ins. diam. brs. S30°W, 1.3 ft. record; 1.5 ft. to face of tree.

Marked new bearing trees 'CS''BT' and measured to center at lower blaze;

- W. fir 7 ins. diam. brs. N30¼°E, 8.1 ft.
- W. fir 12 ins. diam. brs. N78°W, 6.6 ft.

Corner lies approx. 100 ft. east of spur road.

August 18, 2009

B. Beeman

H. Durkee

Kerry K. Bradshaw

Jackson County Surveyor

P. -185

V. - 17°15'