

## FIRST RE-ESTABLISHMENT

GCDB 600700

Section Corner of Township line - Sections 35 & 36, Township 34 South, Range 2 West and Sections 1 & 2, Township 35 South, Range 2 West.

Found original bearing tree to southeast down with scribe visible, stump of bearing tree to southwest, remains of stump to northeast which agrees with the official government field notes.

Set a 2" x 36" galvanized iron pipe 33" in the ground for corner,

From which:

- A 10" white oak scribed C.S. - BT bears S.58½°E. 33.2 feet.
- Scribed a 3" white oak C.S. - BT which bears S.76°W. 29.7 feet.
- Scribed a 10" black oak C.S. - BT which bears N.78°W. 43.9 feet.
- Scribed a 3" manzanita C.S. - BT which bears N.54°E. 22. 3 feet.

October 26, 1944  
C. Z. Boyden  
B. L. Campbell  
R. E. Welch

SEE NEXT PAGE FOR SECOND RE-ESTABLISHMENT

## SECOND RE-ESTABLISHMENT

GCDB 600700

Section corner on the Township line common to Sections 1 and 2, Township 35 South, Range 2 West and Sections 35 and 36, Township 34 South, Range 2 West, W.M.

Found the 2" galvanized iron pipe set for the corner on the first re-establishment by Deputy County Surveyor C. Z. Boyden on October 26, 1944.

Set a 1" x 36" galvanized iron pipe 33" in the ground with a 2½" bronze cap stamped:

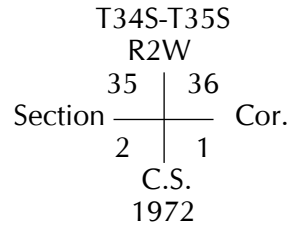

For corner.

From which:

- Found stump holes which agree with the record positions of the original Northeast, Southeast and Southwest bearing trees.
- The bearing tree established on said First Re-establishment, now a 7" White Oak with healed blazes, bears  $S78\frac{3}{4}^{\circ}W$ , 29.6 feet to the center (Record: 3" White Oak  $S76^{\circ}W$ , 29.7 feet).
- The bearing tree established on said First Re-establishment, now a 15" Black Oak with healed blazes bears  $N75\frac{1}{2}^{\circ}W$ , 44.0 feet to the center (Record: 10" Black Oak  $N78^{\circ}W$ , 43.0 feet).
- The bearing tree established on said First Re-establishment, now a 9" White Oak snag with "CS-BT" scribe visible bears  $S56\frac{1}{2}^{\circ}E$ , 33.3 feet to the face of the lower blaze (Record: 10" White Oak  $S58\frac{1}{2}^{\circ}E$ , 33.2 feet).
- Scribed a 14" Laurel "CS-BT" which bears  $S73\frac{3}{4}^{\circ}E$ , 28.9 feet to the face of the lower blaze.
- Scribed a 24" Yellow Pine "CS-BT" which bears  $N42\frac{1}{2}^{\circ}E$ , 55.0 feet to the face of the lower blaze.

February 18, 1972  
G. Kaiser,  
Deputy County Surveyor

Lloyd Shreeve