

FIRST RE-ESTABLISHMENT

DLC80NNE

GCDB 880120

North Northeast Corner of Donation Land Claim 80 located in Section 14, Township 38 South Range 1 West, W.M.

From original evidence set a 1x30-inch flanged galvanized iron pipe 24 inches in the ground with attached 2½-inch diameter brass cap marked:

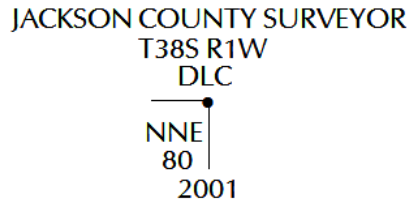

From which the single remaining original bearing tree marked by Truax in 1854:

- White Oak 17-inch diameter below fork, with reverse scribe 'BT' visible on sawed out lower blaze bears Record: N22°W, 100.98 feet to face.
- Root hole with oak remains bears record S4¾°W, 158.00 feet to center of depression.

Marked new trees 'CS BT' and measure to the center of tree at base:

- White Oak 11-inch diameter bears S10°E, 44.05 feet.
- White Oak 12-inch diameter bears S71°W, 74.70 feet.

Corner is located on a West slope in oaks with grassy openings. An abandoned ditch / trail bears West 80 feet. The brass-capped Northwest Corner of Donation Land Claim 80 bears West 409.20 feet. (Calculated)

June 19, 2001

S. Beecher

T. Newcomb

Roger Roberts

County Surveyor

V = 16°

P. - 20