

## FIRST RE-ESTABLISHMENT

GCDB 700700

Section corner common to Section 36 and 31, Township 39 South, Range 3 West and Range 2 West, and Section 1, Township 40 South, Range 3 West and Section 6, Township 40 South, Range 2 West, W.M.  $V = 18\frac{1}{2}^\circ$

Found, projecting 10 inches the 3-inch diameter iron pipe with GLO brass cap marked:

T39S	
R3W	R2W
S36	S31
S 1	S 6
T40S	
MSW	
1917	

In 1917, with notched stone recorded by S. Lackland in 1882, alongside.

Original BTs recorded by S. Truax in 1857 found:

- Rotted Pine stob, 20-inch diameter, scribed "T31S R2W S31 SC BT" in single exposed face bears  $N12^\circ E$ , 34.32 feet to center of stob. Record:  $N11^\circ E$ , 34.32 feet.
- Ponderosa Pine, 23-inch diameter, scribed "T39S R3W S36 SC BT" in single exposed face bears  $N37^\circ W$ , 29.83 feet to center. Record:  $N37^\circ W$ , 29.70 feet.
- **Note:** Above trees apparently re-scribed by Wright in 1917.
- BT recorded by Wright, Ponderosa Pine, now 20-inch diameter with healed blazes bears Record:  $S30^\circ E$ , 29.70 feet to center.
- Wright's SW BT now gone.

I marked new trees CS BT and took measurements to center of tree at lower blaze:

- Douglas Fir, 6-inch diameter bears  $N34^\circ E$ , 14.24 feet.
- Douglas Fir, 5-inch diameter bears  $S38^\circ W$ , 2.70 feet.

Corner lies  $N18^\circ W$ , about 50 feet from location marker on 14-inch diameter pine alongside road and 10 feet West of West shoulder of same road.

January 19, 1977  
B. Malotte  
R. Frost

Approved by: Edward McGinty  
County Surveyor

NEXT PAGE FOR SECOND RE-ESTABLISHMENT

## SECOND RE-ESTABLISHMENT

### GCDB 700700

Section corner common to Sections 36 and 31, Township 39 South, Range 3 West and Range 2 West; and section 1 and 6, Township 40 South, Range 3 West and Range 2 West, W.M.

Found at corner position exposed 7 inches in mound of stones with original stone alongside, the 3-inch diameter galvanized iron pipe with a 3½-inch diameter brass cap set by the GLO in 1917 and marked:

T39S	
R3W	R2W
S36	S31
-----	
S1	S6
T40S	
MSW	
1917	

Original bearing trees recorded by S. Truax of the GLO in 1857 found with single exposed faces and measured to center at base:

- A rotted pine snag with exposed face bears N13½°E, 34.3 feet. Record N12°E showing scribe marks "T31S R2W S31 SC BT".
- Northwest bearing tree, a 23-inch diameter pine found dislodged and lying approximately 25-foot downslope showing scribe marks "9S R3W S36 SC BT" in exposed face.

Single remaining bearing tree recorded by Wright of the GLO on a re-survey in 1917

- A pine snag found with a single exposed face showing scribe marks "T40S R2WS6 SC BT" and measured to center at base. Bears Record: S30°E, 29.7 feet.

Bearing trees recorded on First Re-Establishment in 1977 found with healed double blazes and measured to center at lower blaze:

- Douglas Fir now 9-inch diameter bears Record: N34°E, 14.2 feet.
- Douglas Fir now 10-inch diameter bears Record: S38°W, 2.7 feet.

Marked new bearing trees "CS" "BT" and measured to center at lower blaze:

- Douglas Fir 11-inch diameter bears N29¼°W, 12.6 feet.
- Douglas Fir 9-inch diameter bears S27½°E, 24.8 feet.

Corner lies approximately 15 feet west of inside curve of spur road.

September 19, 2007

B. Beeman  
H. Durkee

Roger R. Roberts  
Jackson County Surveyor

P - 218  
V - 16°30'

SEE NEXT PAGE FOR THIRD RE-ESTABLISHMENT

### THIRD RE-ESTABLISHMENT

#### GCDB 700700

Section corner common to Sections 36 and 31, Township 39 South, Range 3 West and Range 2 West; and section 1 and 6, Township 40 South, Range 3 West and Range 2 West, W.M.

Found at corner position exposed 6 ins. in mound of stones with original stone alongside, the 3-inch diameter galvanized iron pipe with a 3½-inch diameter brass cap set by the GLO in 1917 and recovered per Second Re-establishment, dated 2007, cap marked:

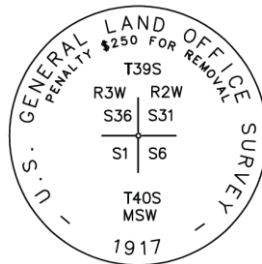

Bearing trees recorded in 2007 found and measured to the center of tree at base:

- A pine snag, rotted, with exposed face and showing scribe marks "T39S R2W S31 SC BT" (note: said re-establishment reports different scribe marks) bears N12°04'28"E, 34.3 feet. Record: N13½°E.
- A pine snag, rotted, with a single exposed face showing scribe marks "T40S R2W S6 SC BT" bears S32°22'58"E, 29.7 feet. Record: S30°E.
- Douglas fir, now 13 ins. diameter, with double healed blazes, bears N29°58'40"W, 12.60 feet. Record: N29°25'W.
- Douglas fir, now 11 ins. diameter, with double healed blazes, bears N34°31'06"E, 14.20 feet. Record: N34°E.
- Douglas fir, now 11 ins. diameter, with double healed blazes, bears S28°28'02"E, 24.80 feet. Record: S27°30'E.
- Douglas fir, now 13 ins. diameter, with double healed blazes, bears S32°32'34"W, 2.70 feet. Record: S38°W.

Take new reference as follows:

- Found 5/8 in. diameter rebar with 1½-inch diameter aluminum cap marked "Jackson County Surveyor", **not of record**, on east side of northwest-southeast bearing gravel road, approx. 60 feet southeast of 28 ins. diameter oak tree, bears S86°16'21"W, 11.84 feet.

Set new reference:

- 5/8 x 24 ins. rebar with 2 ins. diameter aluminum cap marked "Jackson County Surveyor", 3 ins. deep, on west side of northwest-southeast bearing gravel road, approx. 60 feet south of 28 ins. diameter madrone tree, bears S29°10'22"E, 169.33 feet.

Corner is located approx. 12 feet east of a northwest-southeast bearing gravel logging road on an east facing slope.

Basis of Bearing: NAD83 2011 Epoch (2010) OCRS GP/ASH zone per OAR 734-005-00015.

June 25, 2020  
O. Ribanszky

Scott Fein  
County Surveyor